

## System No. W-J-7087

June 13, 2006

F Rating – 2 Hr

T Rating – 0 Hr

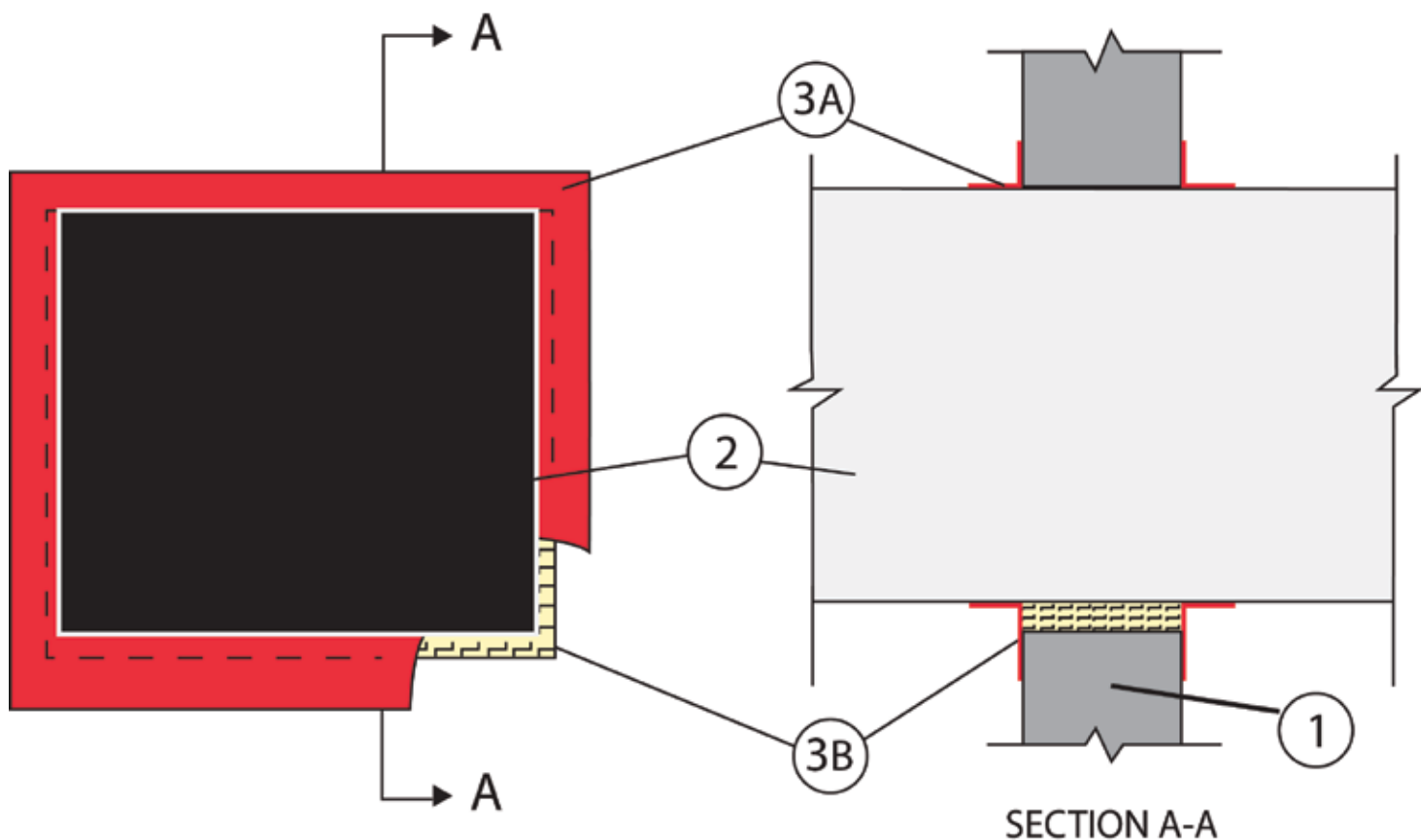

**1. Wall Assembly** – Min 6 in. thick reinforced lightweight or normal weight (100-150 pcf) concrete. Wall may also be constructed of any UL Classified Concrete Blocks\*. Max size of opening is 576 sq in. with a max dimension of 24 in.

***See Concrete Blocks (CAZT) category in the Fire Resistance Directory for names of manufacturers.***

**2. Steel Duct — Nom 23 by 23 in. (or smaller) No. 24 gauge (or heavier) steel duct to be installed either concentrically or eccentrically within the opening. The annular space shall be min 0 in. (point contact) to max 1 in. Duct to be rigidly supported on both sides of wall assembly.**

**3. Firestop System — The firestop system shall consist of the following:**

**A. Packing Material — Min 6 in. thickness of min 4 pcf mineral wool batt insulation firmly packed into opening as a permanent form, flush with both surfaces of wall.**

**B. Fill Void or Cavity Materials\* — Caulk — Min 1/8 in. wet thickness of fill material sprayed or brushed on each side of the wall to completely cover mineral wool packing material and to overlap a min of 2 in. onto wallboard and duct.**

**FLAME TECH INC — Firestop-814+**

**\*Bearing the UL Classification Mark**